

Map Library

Introduction

The General Map Library is the Library Service unit (SdB) responsible for collecting the cartographic documentation at the University. Its collection is made-up of 45,000 maps, 15,000 aerial photographs and 1,400 atlas





General information

Map Library. Universitat Autònoma de Barcelona
L Building (Humanities Library) 3rd floor.
08193 Bellaterra (Cerdanyola del Vallès)
Phone number 93 581 20 45 Fax 93 581 29 00

 [@BHGeografiaUAB](https://twitter.com/BHGeografiaUAB)

 [biblioteques_uab](https://www.instagram.com/biblioteques_uab)

 619681146

 [Pregunta](#)

Hours

September-June: 9.30 to 20.30 h. July: 9 to 19 h.
Easter week, August, Christmas holidays:
CLOSED

Collections

The Map library collects four types of materials:

Maps: collection made up of 45,000 documents. This material is not freely accessible: any queries must be addressed to the staff.

Aerial photography: collection comprising some 15,000 photographs, which partially cover Catalonia from 1956 to 2000. This material is not freely accessible

Atlases and reference works: collection comprised of 1,500 volumes. Freely accessible material, arranged on the shelves by geographic areas and within the areas by subjects. Reference work collection includes inventories, dictionaries, books about the history of cartography, etc.

Digital cartography: collection of several CDs that compiles multimedia cartographic databases. This material is not freely accessible. You can also find two digital collections (Spanish Civil War maps collection and Old Gelabertó maps collection) in the digital repository of the university (DDD): ddd.uab.cat/collection/mapes?ln=en

Services

In addition to the general UAB library catalogue (cataleg.uab.cat), you may consult the collections of maps and atlases at Geodoc, the catalogue for geographic information (www.bib.uab.cat/cartoteca/c9/996.htm#cartot.htm). Only aerial photography collection is not included in the catalogues. You must search in the paper catalogue the material that you need.

The coverage of Catalonia is maximal and decreases for Spain, Western Europe and the rest of the planet.

Reproduction

The Map Library is located within the building of the Humanities Library, which means you can use some of the equipment offered there.

The material only can be borrowed for those kind of reproductions not available inside the building (colour photocopy, for example). Then, loans are made for a day for making reproductions intended to serve as a basis for further work.

Location inside the Humanities Library (3rd floor)

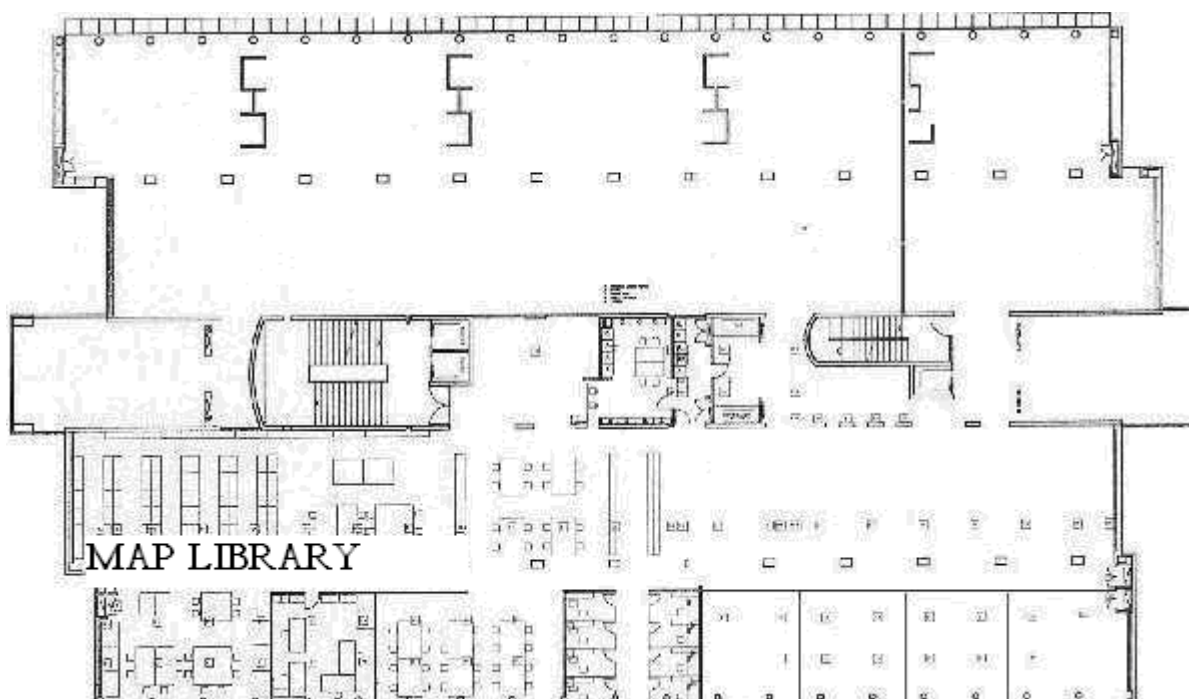

September 2017 edition

Digital version: ddd.uab.cat/record/29874