

7.
LA DOCUMENTACIÓN
DE JOHN DAVIES EVANS (1950)

7.1

DIARIO DE CAMPO DE LA CAMPAÑA DE
EXCAVACIÓN DE 1950 EN LA BASTIDA

(EN INGLÉS)

JOHN DAVIES EVANS

IV TH SEASON OF EXCAVATIONS
AT LA BASTIDA
DE TOTANA

9th Nov. - 6th Dec., 1950

14

SEMINARIO DE HISTORIA PRIMITIVA.

IV CAMPAIGN
AT
LA BASTIDA

9th Nov. - 6th Dec., 1950.

FRANCISCO JORDÁ CERDÁ AND JOHN D. EVANS.

Excavations at La Bastida, 1950.

Thursday, Nov. 9th. Work began on the site at 9 a.m. by Francisco Tordá, who is in charge of the excavation, and myself, with five men, two digging, and the others clearing the earth and stones. We began digging in Square E 14, to the North of the excavation in the previous campaign; this square, of which the Southern portion formed the limit of the work on the last dig, was marked out in accordance with the published plan. Later we decided to mark out two further squares of 3x3m to the S., adjoining squares E 14 and E 13.

In the center of Square E 14 appeared a layer of loose stones which appeared to belong to a fallen wall. Beneath these came vestiges of some piece of gypsum, on the under side of which was a hollow. Suspecting a possible interment, we decided to level out the whole square before proceeding to the investigation.

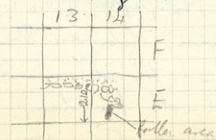

Afternoon. The work of clearing Square E 14 continued. In the Northern part we struck virgin soil rising steeply with the hill. At the base of this appeared the gypsum slabs of a cist at a depth of 1m. 15cm.

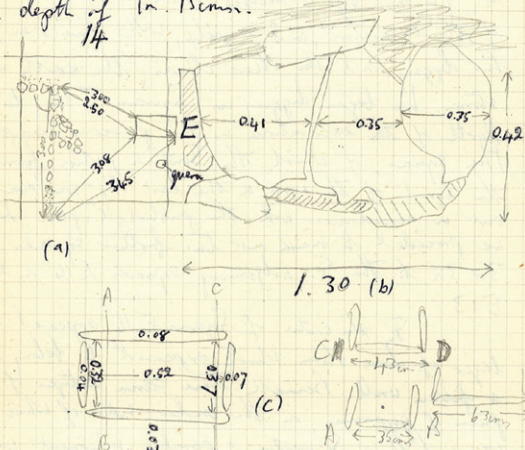

The area was cleared and what was visible of the slabs cleaned and photographed. (Nos 1 & 2 of my first wall). The covering slabs were then lifted without mishap, and the cist (measurement above (c)) appeared filled with fine damp soil. The measurement in (a) are taken from the

cist after the removal of the covering slabs. We next proceeded to clean the area E. of the cist including stones previously considered to be a wall running E. from the ~~west~~ Southern edge of the cist.

We then began removing the earth of the cist and sifting it. There appeared the top rim of a pot, probably a bowl, in the N.E. corner, and later the skull (probably of child) at the S. e.d.



Three fragments of pottery, some loose bones, and a quern appeared in Square E 14. Quern: 28x17x7.

Friday 10th Nov. Morning. Work begun on Square E 15. Perforated shell, and quern found. Quern: 30x15x8.



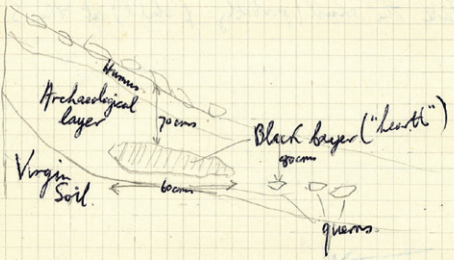
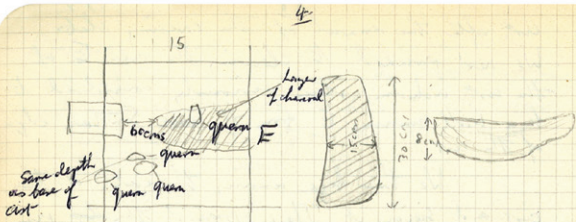

The work of clearing the cist continued. About 12:30 the skeleton was quite well visible, and a fourth pit, at the side of the first, had been excavated. At this point we began photographing the remains (nos 3, 4 & 5 of Pit 2).

Meanwhile several fragments of pottery (one with impressed horizontal lines, & one of fine black polished ware) and 3 more querns (one broken) had come to light in Square E 15 all near the hearth, and at about the same depth as the base of the cist.

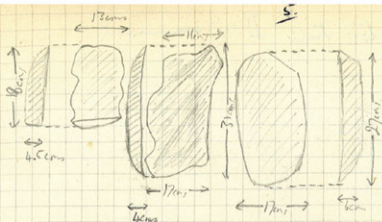

Fragments of pottery with horizontal impressed lines, E 15.

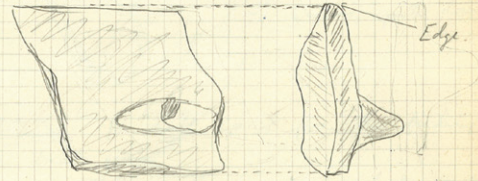

Afternoon:



Work commenced on D 14, and the excavation of E 14 continued. No results.

I made an excursion to the top of the cist, and found shards of the rough red pottery everywhere.

including the top itself. D 15 commenced.

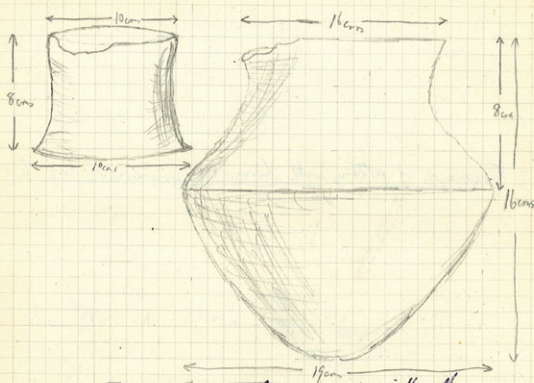

The cist was photographed with the plate camera, and we then proceeded to remove the two pots. The larger contained one or two small fragments of fine ware the soil which filled it.

Saturday, Nov. 11th. The cist was dismantled in my absence in Totem. The two largest stones of the packing proved to be very large querns. The broken part of the wall revealed in the last campaign in E 4 turned out to be a doorway. This became clear when a few loose stones and some of the earth had been removed.

Work began on D 16 and E 16.

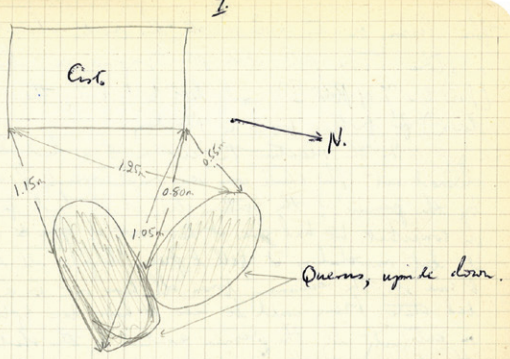

Afternoon N. result apart from the finding of one broken quern.

One of the men noticed a bowl with the north staped with slat of slate in situ in an area excavated in the previous campaign (S.E. corner of Square D 11).

Cleaning operations revealed a larger pit behind.

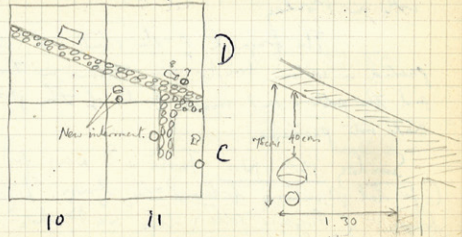

8
 this, lying on its side with the mouth closed into a stone. The pot was photographed in situ (Nos. 6 & 7 of Roll I), and left (it being then almost dark) for further work in Monday.

9. The reaction the cist in E14 had been cleaned out. The skull was very much crushed and by the pressure of the Southern slab, which had fallen in somewhat. We had given it two coats of glue to handle it, but nevertheless it fell to pieces despite all efforts to save it. The remaining bones all came out in a very bad state. Many could be seen to have been split in antiquity by the pressure exerted by the slab at the head and other bones in extraction.

Near the skull was a small carbonised acc, and for the pelvic region came on a tiny minute fragment of copper.

The sifting of the soil produced nothing but minute fragments of the skeleton and a possible bird-bone. A small amount of soil remains in the cist, to be dealt with in Monday.

The fragments of the skull and skeleton were packed in cotton burlap from Totana in the morning, and the pottery and small finds of the previous days made into packages.

Sunday, 12th Nov. Fortia & I went for walk on the Cape side of Antares behind the farm. Discovered one fragment of Pre-Columbian pottery like "La Barahona" in small cavity called "Cueva Negra".

1. Monday, 13th Nov Morning Some fragments of human bones, including part of a mandible appeared in E16. Also a few fragments of pottery, and but having no connection with the bones, which appeared to have no protection. 8 men working

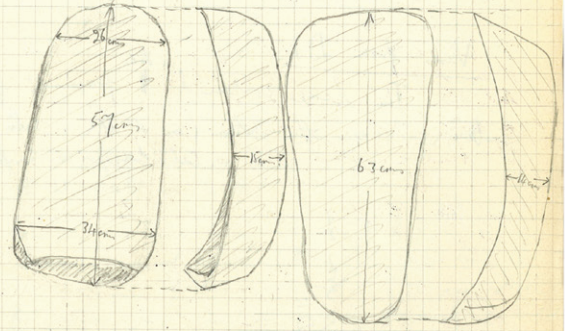

Querns from packing of Cist S1-S0

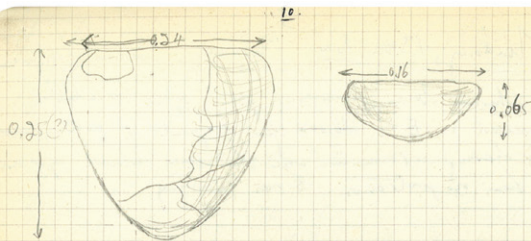
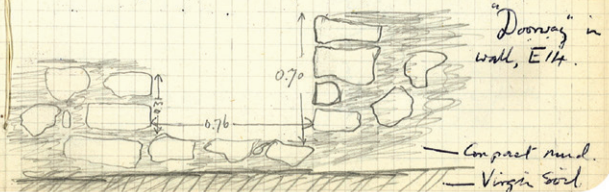

Vases from D11.

The large contained a few fragments of bone, and, near the bottom (as it lay in situ) a small pestle dagger, or knife.

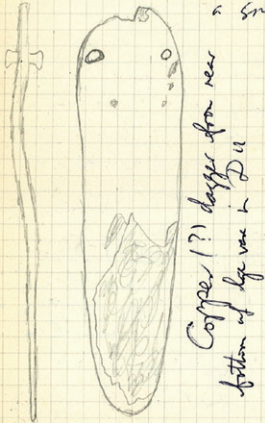

11. Afternoon

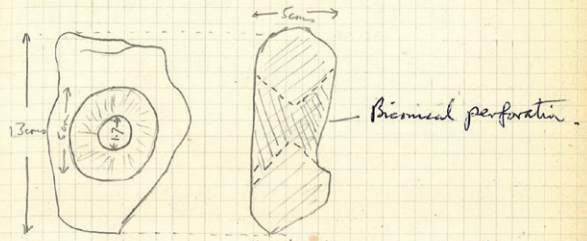

"Digging stick" weight from B14 (line of E-W. wall in E14)

Excavation continued E. Square D14 & C14 attacked. Work of clearing E14 and 15 continued. The fragments of human bones from E16 were collected for packing, and found to include fragments of skull.

Tuesday, 14th Nov. Morning 7 men working, Piza having gone for provisions. Took 2 photographs of "doorway" (E14), the first facing N. & including general view of work, the second a detail, facing S. (Nos. 8 & 9 of Roll I).

Squares E14, 15, 16, and Square D14, 15, 16 cleared out without further find. At this point 2 men began the work of clearing the surface of Square F14, 15 of loose stones to leave it clear for excavation.

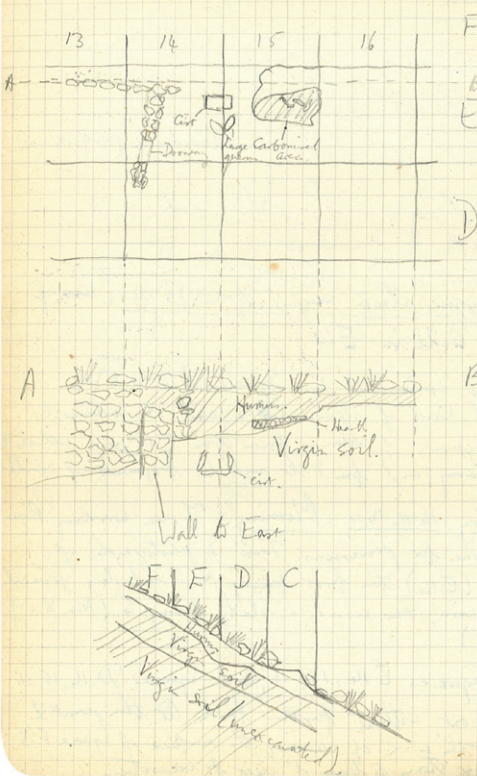

Afternoon Fragment of what appeared to be a large urn appeared in F14 at about 1 p.m. This afternoon the urn was brought to light, and also the fragment of a further urn at right angle to it. The first urn had been combed by the stone above it, and the second was in an even worse state. In the angle between the two, and to the west, appeared fragments of various pots, some of very fine ware and with intimated edges, others coarser. Photographs were taken of the whole complex. (Roll I, 10, 11, 12)

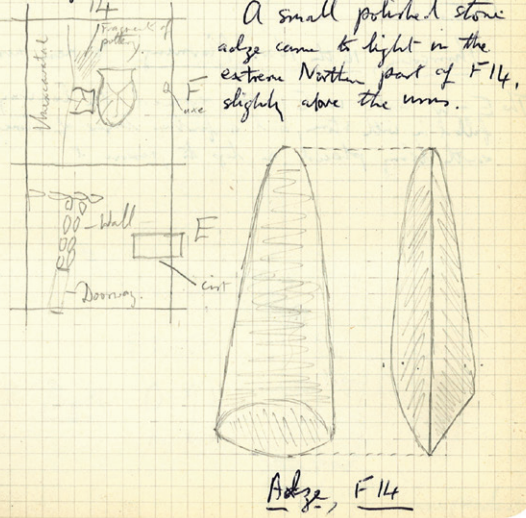

A small polished stone adze came to light in the extreme Northern part of F14, slightly above the urns.

Wednesday, 15th Nov Morning 8 men working. A new wall, oriented NE-S.W. came to light in Square E 13, N.W. section. This was very much smashed by the pressure on the large stones which packed it in. The cleaning of this I (the best preserved), S 2-50 was proceeded with, and the skeleton, much smashed, was partially uncovered. It was about midway this period in totana.

Afternoon. The cleaning of S 2-50 continued, and the new wall photographed with the Contax.

Thursday, 16th Nov. Morning 8 men working.

The E-W wall in E 14 was repaired. The lowerway being filled in with stone, and a further layer of stone and earth being placed on top to preserve it.

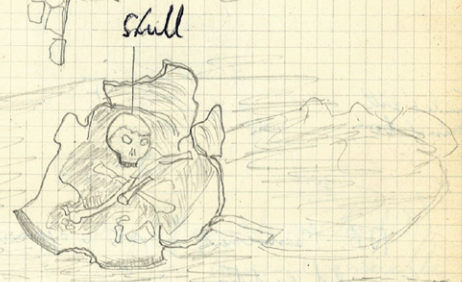
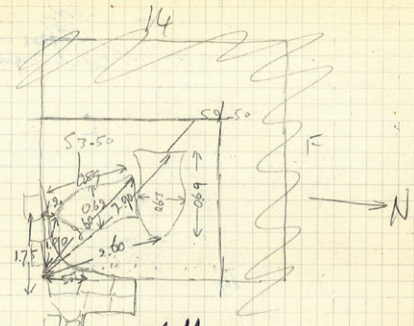
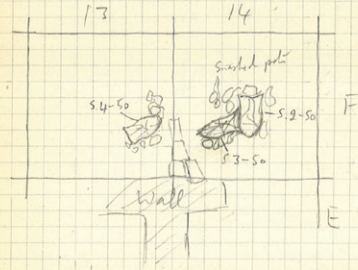

S 2-50
Depth: 0.95
1.05

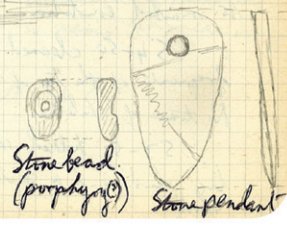

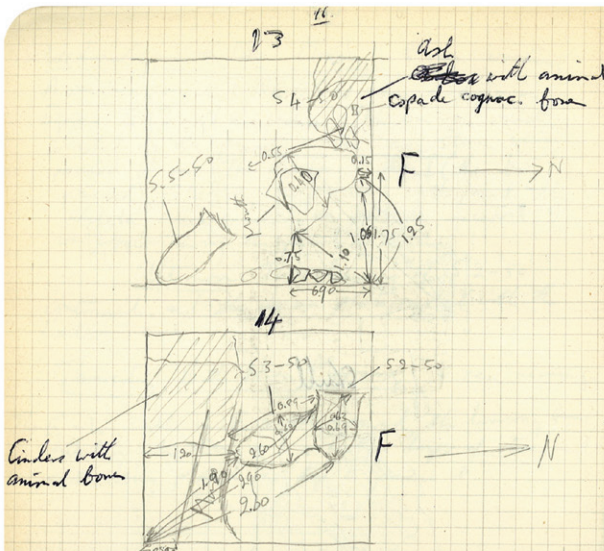

N.B. Measurements of pits v. approximate, owing to smashed condition.

S4-50 cleaned. Yielded nothing, but smashed fragment of the top of the iron was found throughout. No trace of skeleton.

S3-50 yielded skeleton with skull smashed by large shield, and a small dagger or left joint below skull.

17. S5-50, on iron, smashed on top and on the E. side appeared with saw orientation as S4-50, to S.E. in same square. The mouth in this case was to the N.W.

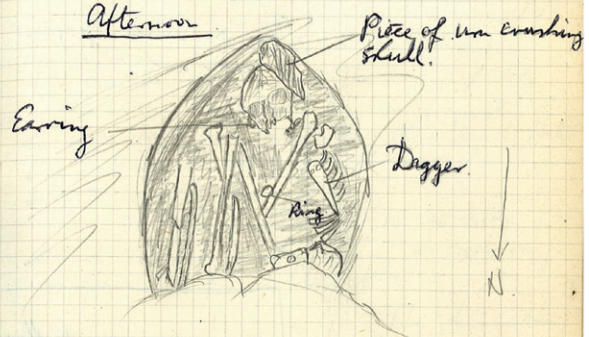

S3-50.

Ring (Argentiferous lead?)
S3-50. A second appeared by right ear, so seems were ear-rings
Depth: 1.05

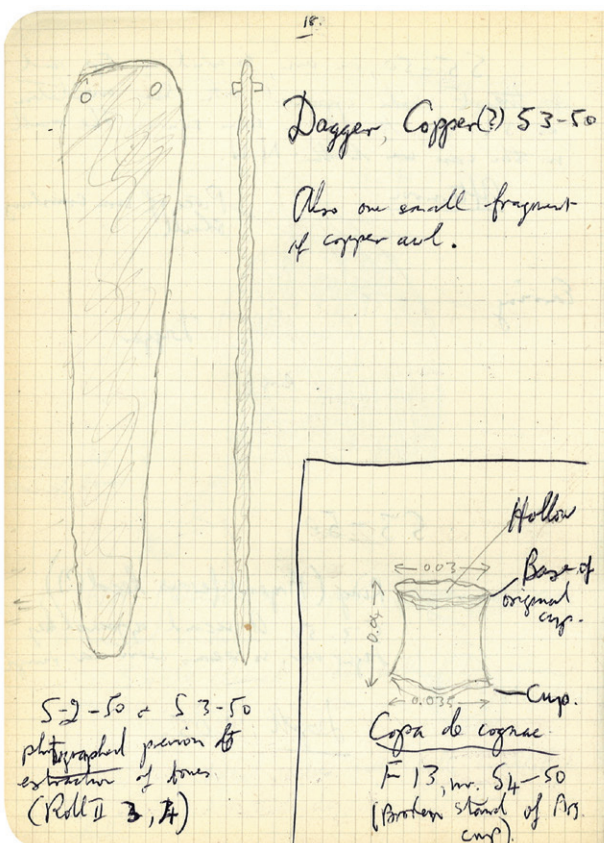

S2-50 & S3-50 photographed previous to extraction of bones (Rolls 3, 4)

19. S5-50 Depth 0.40
0.55

Friday, 17th Nov. Morning. 8 men working. The work of clearing S2-50 and S3-50 was continued and completed; the skulls in both cases was saved intact. The sifting of the soil in S2-50 yielded two iron fragments of the copper and, and one further stone bead. Later 6 more beads, two being bone, the rest stone, appeared below the smashed piece of iron.

The work of clearing F15 was begun, and toward the end of the morning a copper ring was found in the debris below.

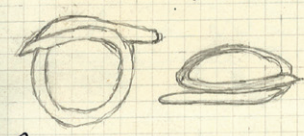

The dismantling of S5-50 was begun

Afternoon S5-50 finished. A few bones appeared, crushed, and pushed almost out of the remains of the iron to the E. These were photographed, and the ground was then dismantled. Nothing appeared from the sifting of the earth.

In F 14 appeared a wall continuing the E.-W. wall of E 14. The layer of ash, broader than was thought, continued under this. On the N. side, a little above the furnace S 2-50 + S 3-50 appeared a post, upside down, and firmly fixed into the wall. Its mouth rested on virgin soil, and its neck passed through the ash layer. Photographs (Nos 6, 7, 8 of Roll II).

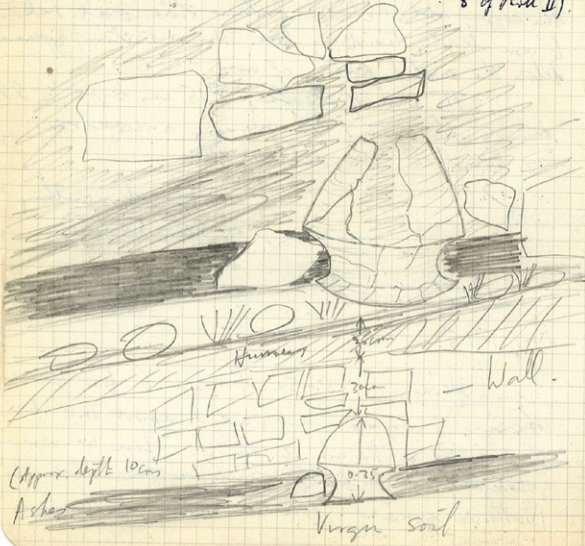

Saturday, 18th Nov. Morning. The

post in E 14, mentioned yesterday, was cleared out. It appeared filled with stone, some of quite large size, a certain amount of virgin soil (some of it appeared to have been baked hard by fire, and some black burning, intermixed with spots of charcoal towards the top. The top (i.e. the bottom of the vase) seemed to have been broken off before it was deposited in the soil. Some small fragments of pottery appeared among the stones near the mouth, and a minute fragment of bone was found among the earth.

Afternoon Further examination of the wall in which the post appeared revealed a gap between it and the N.S. wall, which latter was buttressed at the N.W. corner by a broadening which did not quite reach the height of the wall itself.

Remains of a further wall (height only one course of stones), running N.W. from S 4-50. This seems a possible old wall, which had fallen or been demolished in a later time. A further N.S. wall came to light in G 12 and 13, near to F, with a well marked angle in G 13. All the remains to look in of S 4-50 and S 5-50 were both outside the rooms.

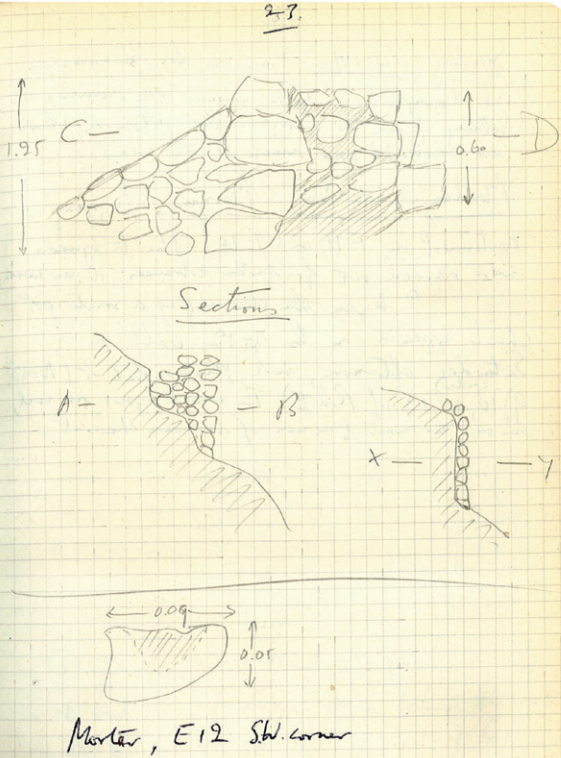
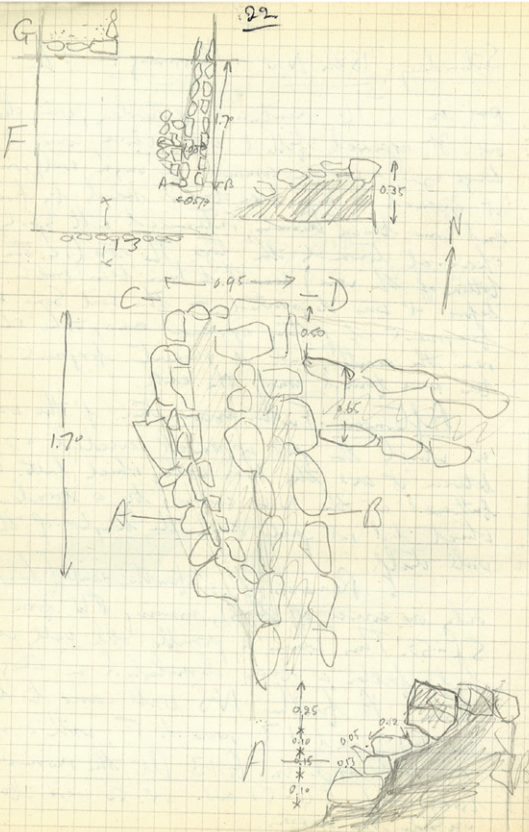

Sunday, 19th Nov Visit to Les Blanchettes and Campes de Labor during the morning. Nothing found at Campes but pits, which were scattered over much of the area.

Monday 20th Nov Morning - Digging continued in F11 and F10. The G squares were marked out for further advances. 10 men working. I began the cleaning of a small pit which appeared in the G12 wall on Saturday afternoon, and photographed it (Nos 8, 9, 10, 11, 12 of Roll II). The contents, apart from soil, was one or two minute fragments of bone and charcoal.

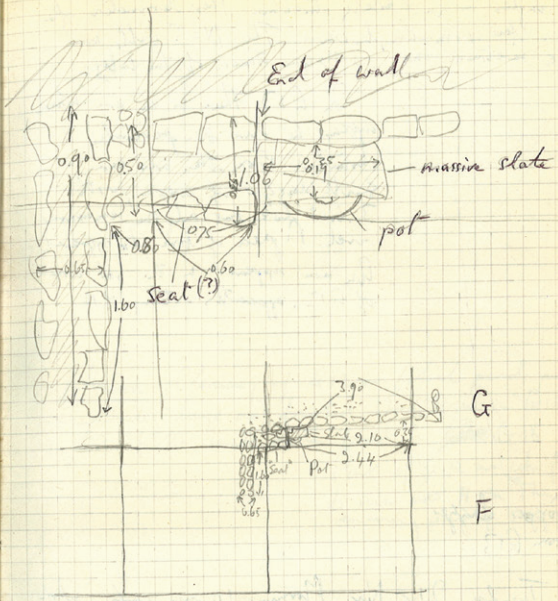
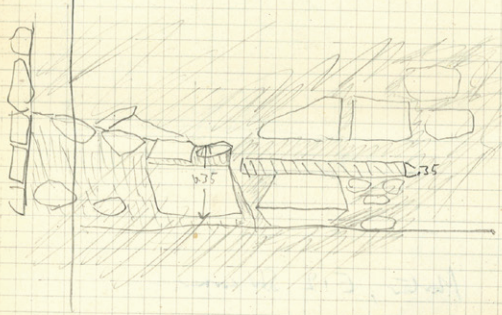

Afternoon F11 and 10 finished, also G10 and 11, and digging begun behind the wall in G12 and 13. In the W part of G10 and 11 appeared a wall of smallish stones running N-S, and with other walls beginning at right

angles in an E-W direction. These terminated after a few centimetres, however. The N-S wall was a rectangle, only one stone thick of the layer.

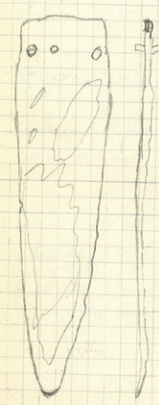

Copper "dagger" from G13.

In G13 there is an area which appears to have been previously disturbed. From this we came small dagger of copper, with 3 rivet holes, but only one remaining rivet. A piece of bone also appeared. An urn appeared in the SW corner of G12, apparently entering H12.

Tuesday, 21st Nov Morning 10 men working. Work continued behind wall in G12 and 13. A fragment of wall found, which was slightly visible above ground previously, having been closed in a previous excavation (i.e. bombardment!). The reverse face of the original wall was cleared up and the cleaning of the G12 was begun.

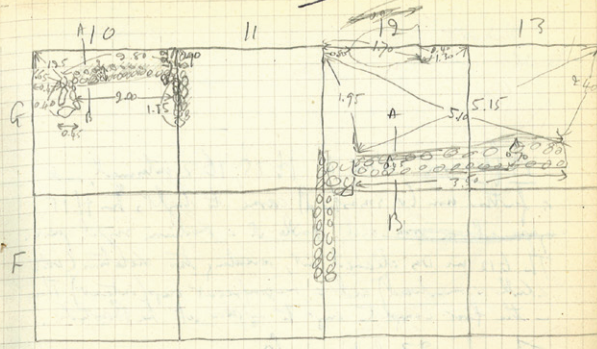

Afternoon Cleaning of G12 was (which proved an exceptionally large one) finished. Work begun on G14, 15, 16. One further small "mortar" found in G15.

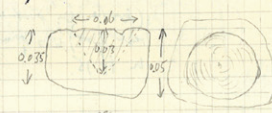

"Mortar" from G15.

Part of G12 was found to run into H12. The remaining part of F16 finished.

Wednesday, 22nd Nov Morning - Proceeded to the clearing of H15, 16. Photographed urn (G12, H12), with Cortax, slate and my camera (Roll III, 12, 3). Dimension of G12 urn: length 0.35. Width 0.70. Mouth 0.65. Depth 0.40. 10 men working.

Afternoon Work in H 15, 16 continued, and a further urn (v. smashed) came to light, in H 15, ~~opposed~~ ~~a~~ ~~urn~~ ~~and~~ ~~beside~~ ~~it~~ ~~a~~ ~~medium~~ ~~sized~~ ~~urn~~. The G12 urn was cleared out, revealing two skeletons (with skulls v. smashed) and a magnificent cup (intact). This - the first complete cup to appear at La Bastida.

Thursday 23rd Nov Morning 10 men working. Work continued in H 15 and commenced in H 14.

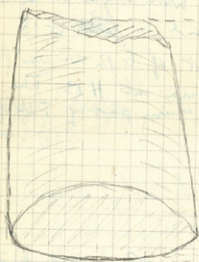

A fragment of stone edge (broken by pick & rest lost) was found in H 15.

Adze from H 15, depth 0.80.

Skull I shld be somewhat larger.

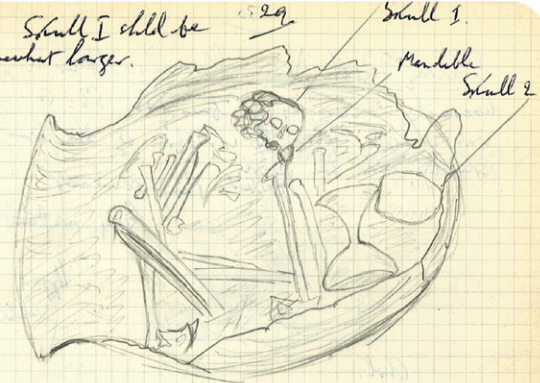

S 6-50.

The cleaning of S 6-50 finished and the result photographed with all three cameras (Roll III, Nos 4, 5 (spoiled), 6, 7, 8)



Shell, pearl though rather, from H 15.

Afternoon Work continued in H 14. One small pearl shell found & several ~~small~~ querns.

Skull I of S 6-50 proved to have a copper ring - pendant below the jaw.

Friday 24th Nov Morning Halberd discovered in clearing the bones from S 6-50. It was wedged below the vertebrae of the lower skeleton, near the pelvis.

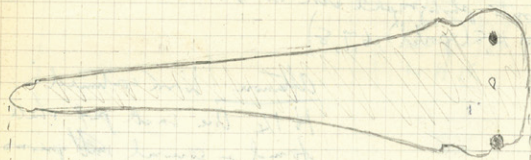
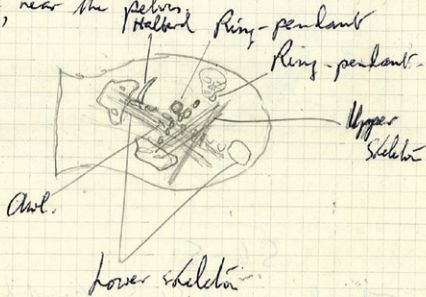

Halberd, S 6-50.

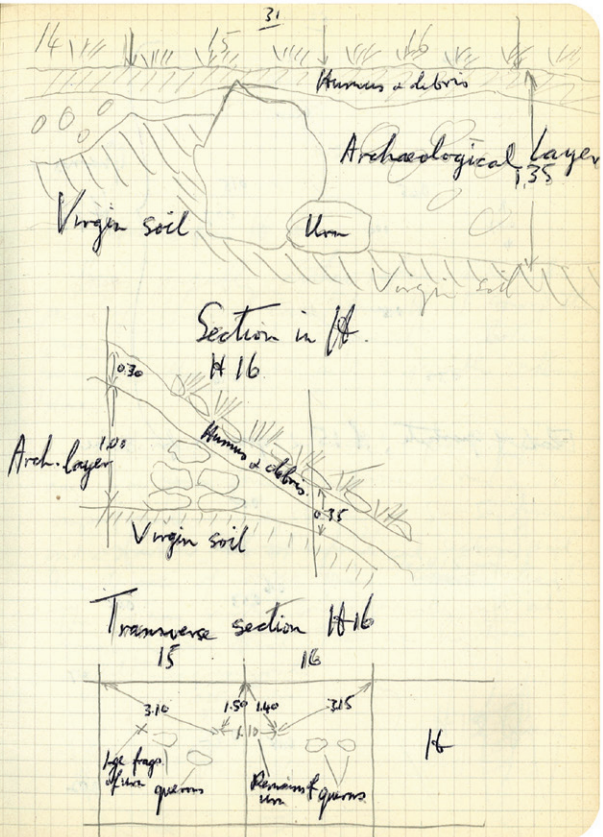

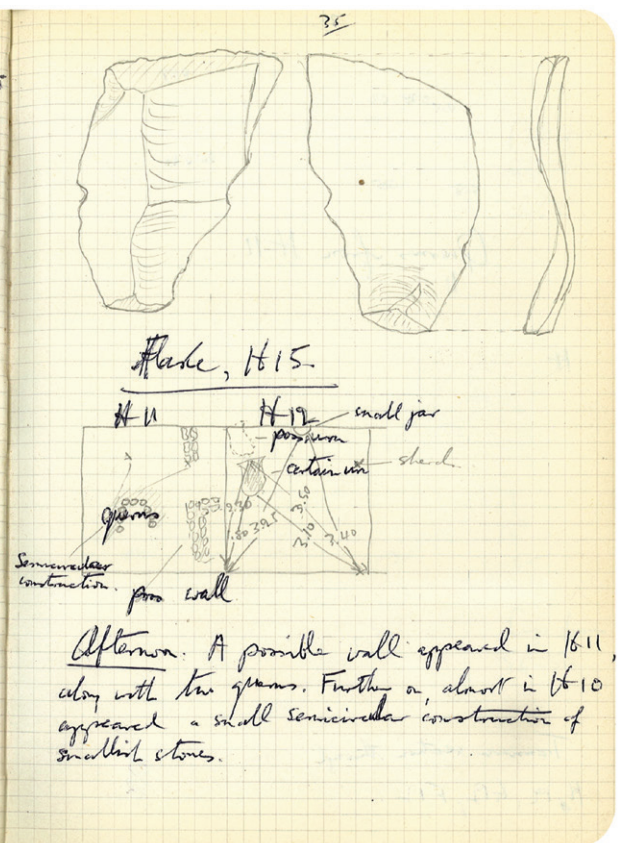
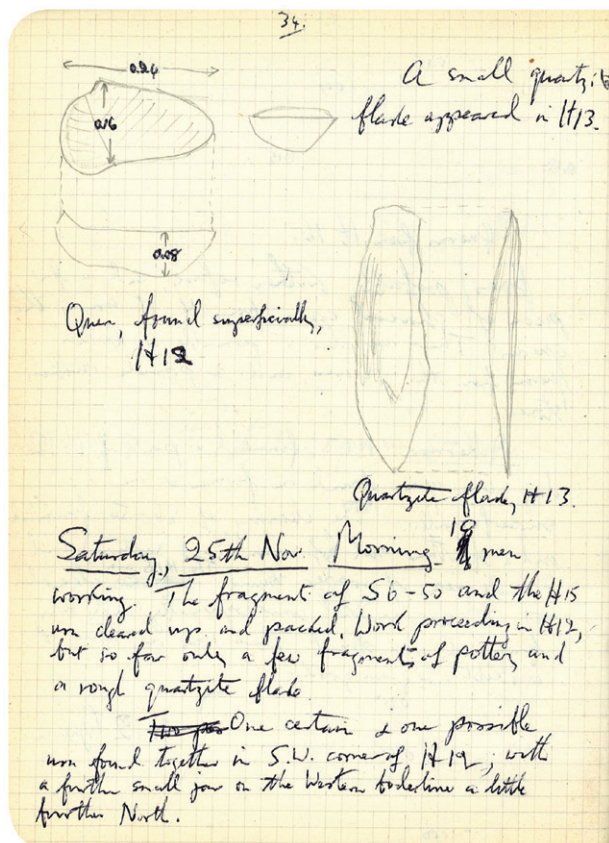
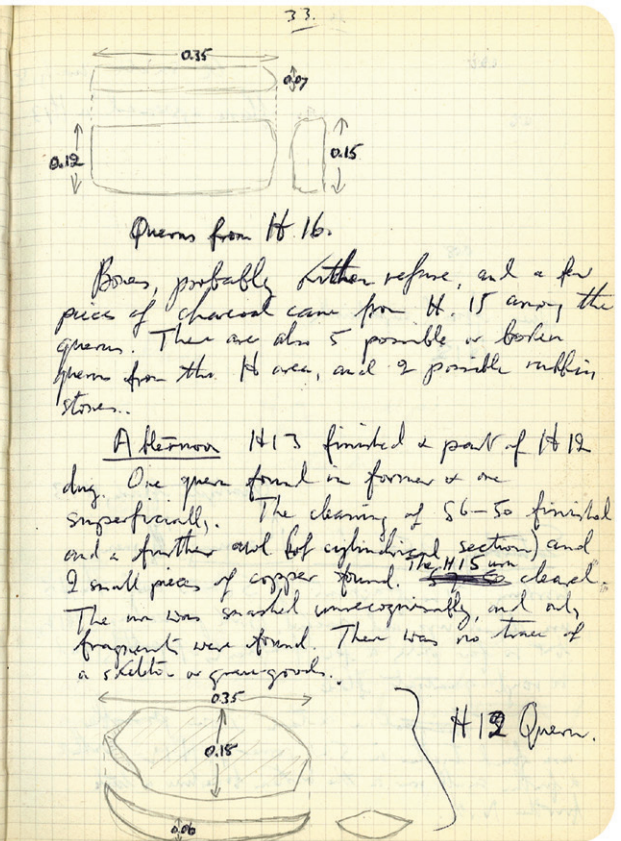
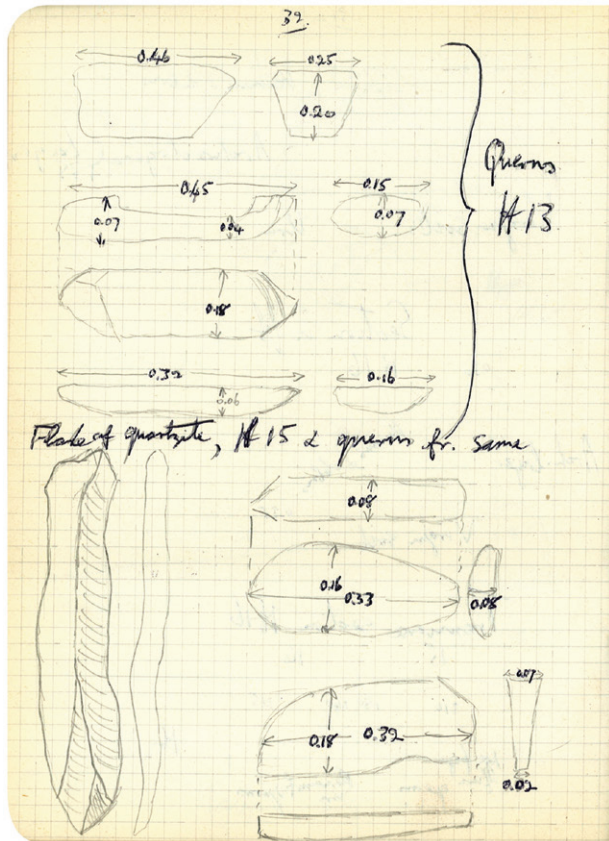

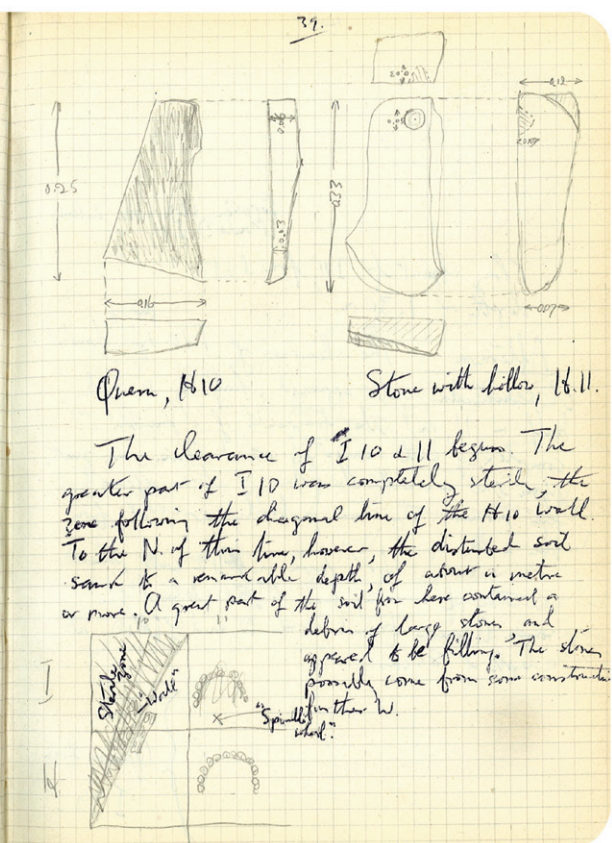
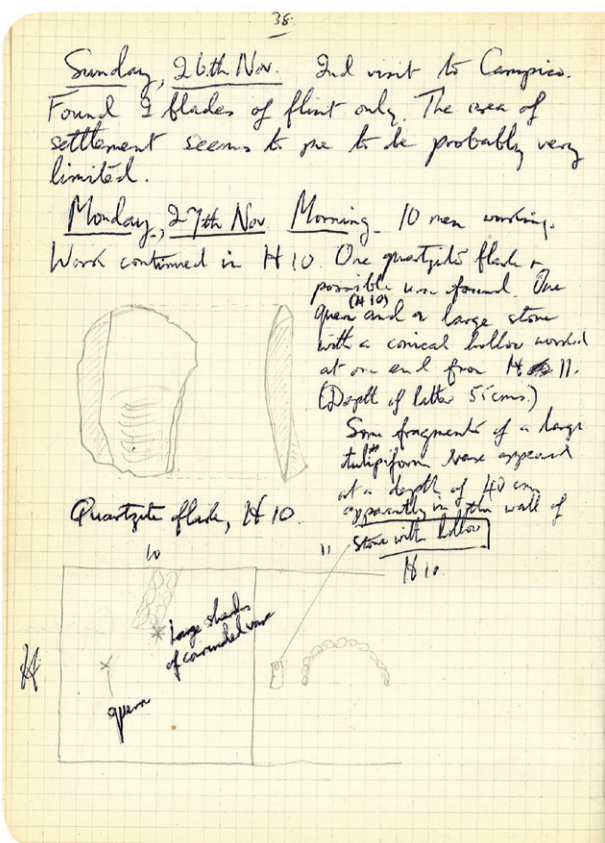
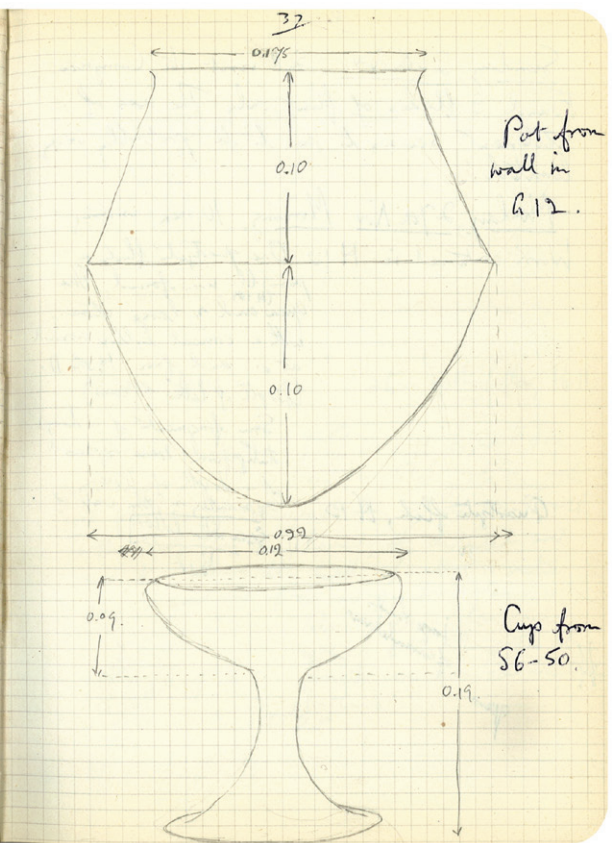
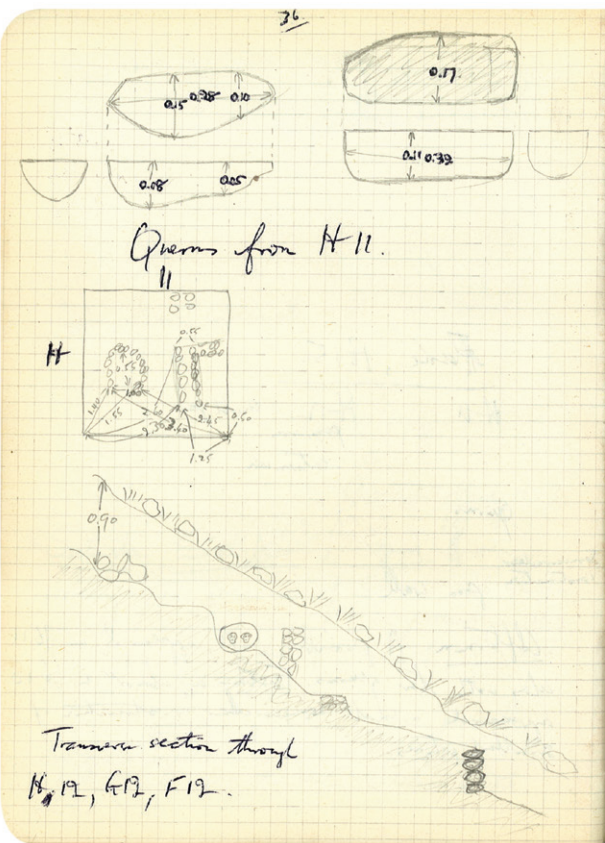

40

Broken stone with hollows (Mould?) I 11

Clay object for I 11, found at depth of 1.30 m.

Afternoon The clearance of I 10 & I 11 finished. A semicircular wall appeared, half in 10 and half in 11, and also fragments of a possible complex of walls connected with it. This was just above the area with the filling of stones referred to this morning. The stone probably provided from the wall.

Work begun in I 12 with the intention of working back to I 11 behind the rows. A green found at the N. end of I 12 at a depth of 85 cms.

} Quern from I 12.

41

Broken Quern, I 12, nr. square & at approx. same depth.

Tuesday, Nov 28th Morning Part of I 12 and the whole of I 13 cleared to a considerable depth, but with no further finds. The walls in I 10 and 11 were cleaned, & men working upon clearing the soil from behind the original semicircular construction in H 11 it became evident that this was a purely accidental arrangement of stones and had no real existence. One of these stones proved to be a quern.

} Quern, H 11.

42

Afternoon 10 men working. Part of I 12 cleared & work continued to N. in I squares.

43

Wednesday, 29th Nov. Morning - The clearing of the new wall I 11 (Northern extreme) end of the enormous quantity of earth from squares I 12, 13, 14 continued. The new wall is about 1.60 cms high at its W. extreme, when the soil of the Carazo was changed. A few small pieces of charcoal and 3 quartzite flakes came from the base of the disturbed soil a few cms to the N. of the W. extreme of the wall (I 12). Depth 1.60 m.

Quartzite flakes, I 12.

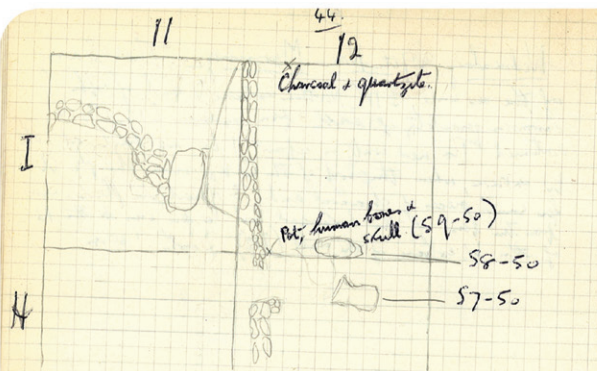

A quen for I13

Afternoon Some earth still remained to be removed from I12, and the area of the urns (H, I 12) to be cleared. A green and kind of mortar (like stone with big hollows on one side) came from the area between the two (H, I) the urn which enters I seem to be only some large fragments of the base of the wall when it is parallel with the latter appears a large fragment of pot + human bones, including the whole or part of a skull. This will have to be investigated tomorrow. A small fragment of a bone point has also been found. I12, when fragments of pottery, of animal bones + charcoal are quite frequent. A fragment of what appears to be a polished ware also found in this area a small bone which seems

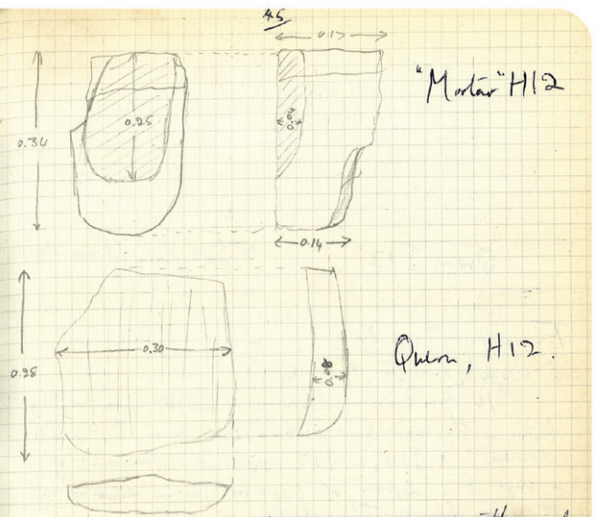

to be ringed by 2 deliberate grooves, one at either end. A further quen came from I13.

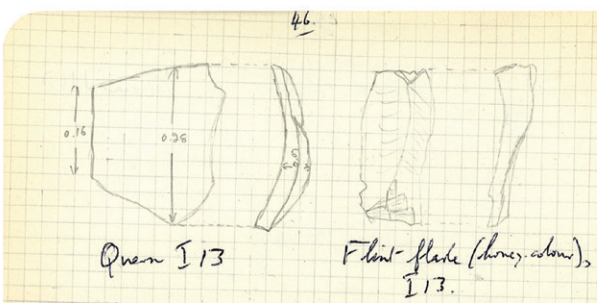
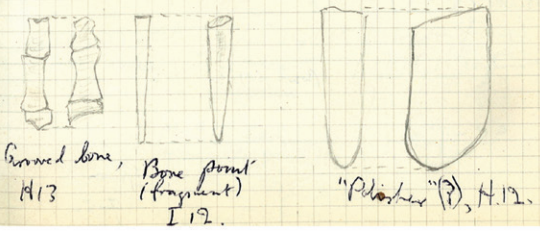

Thursday 30th Nov Morning - Went a visit to Alabo (Roll III 9, 10, 11, 12).

10 men working. Clearing of deeper levels in I13 began, at the same level (1.80-1.90) as in I12, & I11 reached. In I14, nr. I13 appeared a fragment of a cup at a depth of 1.40 m. Various remains of urns found. The clearing of H12 urn begun.

S7-50 Small, much smashed urn, with shel. of child. Small shalloes and of v. good quality paste by hand.

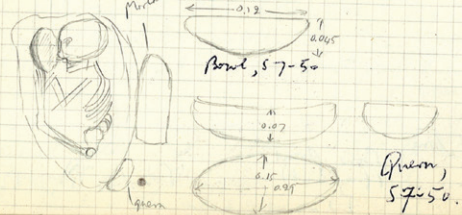

Body extended with legs twisted up towards head.

Afternoon S7-50 photographed (Roll IV, No 1) and then dismantled. The pot was found to be broken but held together by the earth inside. The skull at the base of the I12 wall was investigated & turned out to be a much smashed double interment in an urn. The skull appear to be in good condition for some reason. The small jar in I12 was only shards, but just to the S. of them appeared a few human bones associated with skull of an urn. (S8-50)

The clearing of I14, 15, 16 begun.

Friday 1st Dec. Morning S9-50 (the double interment) cleaned for photographing. The upper part of a large cup appeared to the E of the skulls.

In I15, 16 appeared remains of various E.W. walls. These were followed into I15, 16, and the Squares T10 - T16 were marked out. 10 men working.

Afternoon S8-50 cleared. Skulls came out whole in dirt cup (or fragment of same). The clearing of I15, 16 continued. Mandible belonging apparently to skull. Skulls Upper mandible. Fragment of cup.

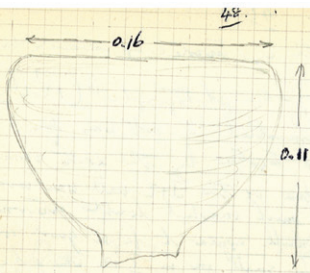

Fragment of cup, Sq-50

Saturday, 2nd Dec Morning - 10 men working. The clearing of J 14, 15, 16 finished, and that of J 13, 12 embarked upon. There is a sudden rise of the ground above the J line, and from then on the layer is very shabby so that the clearing of these squares proceeded rapidly. The ten walls found yesterday were followed through these squares but the first two with disappearance shortly after entering J. The fragment of a pot was found on the landing line between I & J 13. These were removed, and found to be red, cheap. They were surrounded by a mass of fire-hardened clay. Depth approx 1.80

The entrance S8-S9 Sq-50 were cleared completely, apart for one or two bones and a shard or two, nothing of great interest in this process. Sq-50 appears only to contain remains of one skeleton & these incomplete. The lower jaw of one of the skulls (prob. Skull I, which seem to be that of a youth) is still missing.

Afternoon

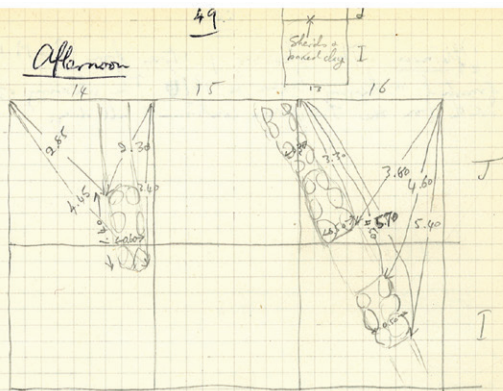

J 12 & 13 finished

Sunday, 3rd Dec. Visited Calzo de Trazo Crismson for second time, but found nothing notable except the pits of earlier excavator.

Monday, 4th Dec 10 men working. J 11 & 10 cleared & found to be completely devoid like most of J 12 & 13. The clearing of the stone from A, B & A 14-16 begun so that these can be excavated & left clear for the future.

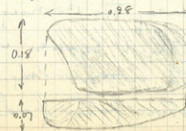

Queen found resting on top of S. corner of semicircular wall in I 10.

Afternoon The clearing of stone from B & A 14-16 finished & digging begun in B 16. The clearing of earth from the B squares continued all day.

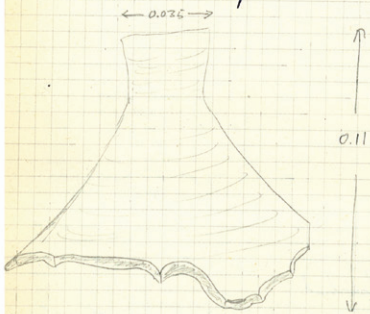

Fragment of cup from I 14 (lower half of that from Sq-50)

Tuesday, 5th Dec Clearing of earth excavated from I 10, 11 & 12 continued.

C 16 commenced. Barren, as C 16.

C 14 commenced.

Clearing of I 10, 11 & 12 finished & clearing of earth from C squares proceeded with 10 men.

Wednesday, 6th Dec During the morning the clearing of earth from the C squares was finished and 1.50 m. of the corresponding B squares was excavated without further finds.

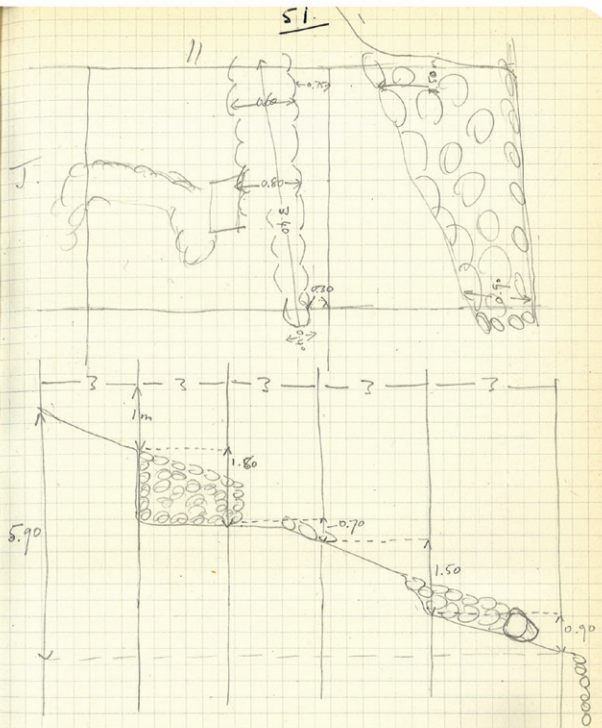

FINIS.

7.2
TRANSCRIPCIÓN DEL
DIARIO DE CAMPO DE LA CAMPAÑA DE EXCAVACIÓN
DE 1950 EN LA BASTIDA

(EN INGLÉS)

VICENTE LULL, RAFAEL MICÓ, CRISTINA RIHUETE Y ROBERTO RISCH

[Portada]

SEMINARIO DE
HISTORIA PRIMITIVA

IV CAMPAIGN

AT

LA BASTIDA

9th Nov. - 6th Dec., 1950

FRANCISCO JORDÁ CERDÁ AND JOHN D. EVANS

[Portada - reverso en blanco]

[Página 1]

Excavations at La Bastida, 1950.

Thursday, Nov. 9th. Work began on the site at 9 a.m. by Francisco Jordá, who is in charge of the excavation, and myself, with five men, two digging, and the other clearing the earth and stones. We began digging in Square E14, to the North of the excavation in the previous campaign; this square, of which the Southern portion formed the limit of the work on the last dig was marked out in accordance with the published plan. Later we proce[e]ded to mark out two further squares of 3 x 3 m to the S., adjoining squares E14 and E13.

In the centre of Square E14 appeared a layer of loose stone which appeared to belong to a fallen wall. Beneath these came vestiges of some pieces of gypsum, on the under side of which was a hollow. Suspection a possible interment; we decided to level out the whole square before proce[e]ding to the investigation.

[Croquis de los cuadros E-F / 13-14 con ubicación de una estructura muraria]

[Página 2]

Afternoon. The work of clearing Square E14 continued. On the Northern part we struck virgin soil rising steeply with the hill. At the base of this appeared the gypsum slabs of a cist at a depth of 1 m. 15 cms.

[Croquis del cuadro E-14 con ubicación de la cista por triangulación]

[Dibujo en planta de la cista con las lajas de cubrición, acompañado de indicaciones métricas]

[Dibujo en planta de la cista una vez levantadas las lajas de cubrición, acompañado de indicaciones métricas y la localización de las secciones detalladas a continuación]

[Sección transversal del interior de la cista según el plano C-D, acompañada de dimensiones métricas]

[Sección transversal del interior de la cista según el plano A-B, acompañada de dimensiones métricas]

[Sección longitudinal del interior de la cista, acompañada de dimensiones métricas]

The area was cleared and what was visible of the slabs cleaned and photographed (Nos 1 & 2 of my first roll). The covering slabs were then lifted without mishap, and the cist (measurements stone) (c) appeared filled with fine damp soil.

The measurements in (a) are taken from the

[Página 3]

cist after the removal of the covering slabs. We next proceed to clearing the area E. of the cist including stones previously considered to be a wall running E. from the Southern edge of the cist.

We then began removing the earth of the cist and sieving it. There appeared the rim of a pot, probably a bowl, in the N.E. corner, & late the skull (probably of child) at the S. end.

[Dibujo en planta del interior de la cista, donde se aprecia lo que parece ser un vaso de ajuar y un cráneo]

Three fragments of pottery, some loose bones, and a quern appeared in Square E14. Quern: 28 x 17 x 7.

Friday 10th Nov. Morning. Work begins on Square E15. Perforated shell, and quern found. Quern: 30 x 15 x 8.

[Dibujo en vista superior de una concha]

[Página 4]

[Croquis del cuadro E15, donde se sitúan en planta diversos hallazgos]

[Secciones de un molino, con indicaciones métricas]

[Sección estratigráfica, presumiblemente del cuadro E15, donde se anota la posición de tres molinos, mencionados más adelante]

The work of clearing the cist continued. About 12,20 the skeleton was quite well visible, and a further pot, at the side of the first, had been uncovered. At this point we began photographing the remains (nos 3, 4 & 5 of Roll I).

Meanwhile several fragments of pottery (one with unperforated lug, & one of the fine black polished ware) and 3 more querns (one broken) had come to light in Square E15 all near the hearth, and at about the same depth as the base of the cist.

[Página 5]

[Dibujo de molino, vista superior y sección lateral, con indicaciones métricas]

[Dibujo de molino, vista superior y sección lateral, con indicaciones métricas]

[Dibujo de molino, vista superior y sección lateral, con indicaciones métricas]

Fragment of pottery with horizontal impressed lug, E15.

[Dibujo de un fragmento cerámico de borde con asa, en vista frontal y sección]

Afternoon:

[Dibujo en planta del interior de la cista que muestra la colocación del esqueleto y de dos vasijas de ajuar]

Work commenced on D14, and the excavation of E14 continued. No results.

I made an excursion to the top of the cabezo, and found sherds of the rough red pottery everywhere

[Página 6]

including the top itself. D15 commenced.

[Dibujo de perfil de una vasija de F8, con indicaciones métricas, parte del ajuar de la cista]

[Dibujo de perfil de una vasija de F5, con indicaciones métricas, parte del ajuar de la cista]

The cist was photographed with the plate camera, and we then proceeded to remove the two pots. The larger contained one or two small fragments of bone among the soil which filled it.

Saturday, Nov. 11th. The cist was dismantled in my absence in Totana. The two largest stones of the packing proved to be very large querns. The broken part of the wall revealed in the last campaign in E14 turned out to be a doorway. This became clear when a few loose stones and some of the earth had been removed.

Work begun on D16 and E16.

[Página 7]

[Croquis con la ubicación mediante medidas de triangulación de dos grandes molinos, en relación a con la cista desmontada]

Afternoon. No results apart from the finding of the broken querns.

One of the men noticed a bowl with the mouth stopped with slab of slate in situ in an area excavated in the previous campaign (S.E, corner of Square D11). Cleaning operations revealed a larger pot behind.

[Dibujo de los cuadros D-C / 10-11 con representación en planta de estructuras murarias y los enterramientos, con la indicación del nuevo enterramiento]

[Dibujo con la ubicación del nuevo enterramiento, urna y ajuar externo]

[Página 8]

This, lying on its side and with the mouth closed with a stone. The pots were photographed in situ (Nos 6 & 7 of Roll I), and left (it being then almost dark) for further work in Monday.

In the meantime the cist in E14 had been cleaned out. The skull was very much smashed by the pressure of the Southern slab, which had fallen in somewhat. We had given it two coats of glue to harden it but nevertheless it fell to pieces despite all efforts to save it. The remaining bones all came out in a very bad state. Many could be seen to have been split in antiquity by the pressure exerted by the slab at the head and others broke in extraction.

Near the skull was a small carbonized area, and from the pelvis region came one or two minute fragments of copper.

The sieving of the soil produced nothing but minute fragments of the skeleton and a possible bird-bone. A small amount of soil remains in the cist, is to be dealt with on Monday.

The fragments of the skull and skeleton were packed in carton brought from Totana in the morning, and the pottery and small finds of the previous days made into packages.

Sunday 12th Nov. Jordá and I went for walk on the Cejo del Pantano behind the fan. Discovered one fragment of Argaric pottery like "La Bastida" in small cavity called "Cueva Negra".

[Página 9]

Monday, 13th Nov Morning. Some fragments of human bones, including part of a mandible appeared in E16. Also a few fragments of pottery but having no

connection with the bones, which appeared to have no protection. 8 men working.

[Dibujo de un molino, con vistas superior y sección longitudinal, acompañado de medidas]

[Dibujo de un molino, con vistas superior y sección longitudinal, acompañado de medidas]

Querns from packing of Cist S1-50

[Dibujo del umbral mencionado en E14, con indicaciones métricas. Anotaciones: "Doorway' in wall, E14", "Compact mud" y "Virgin soil"]

[Página 10]

[Dibujo de perfil de una vasija alta de F2, con indicaciones métricas]

[Dibujo de perfil de un cuenco bajo de F2, con indicaciones métricas]

Vases from D11.

The large contained a few fragments of bone, and, near the bottom (as it lay in situ) a small metal dagger, of knife.

[Dibujo frontal de un cuchillo, sin indicaciones métricas. Anotación: "Copper (?) dagger from near bottom of large vase in D11"]

[Página 11]

Afternoon

[Dibujo en vista superior y sección de una pieza lítica de contorno irregular con una perforación central de sección bicónica]

Digging stick weight from B14 (line of E-W wall in E14)

Excavation continued E. Square D14 and C14 attached. Work of clearing E14 and 15 continued. The fragment of human bones from E16 were collected for packing, and found to include fragments of skull.

Tuesday, 14th Nov. Morning. 7 men working, Pepe having gone for provisions. Took 2 photographs of "doorway" (E14), the first facing N. and including general view of work, the second a detail, facing S. (Nos. 8 & 9 of Roll I).

Squares E14, 15, 16, and Squares D14, 15, 16 cleaned out without further finds. At this point, men began the work of cleaning the surface of Squares F14, 15 of large stones to leave it clear for excavation.

[Página 12]

[Planta de los cuadros 13-16 / E-D, con ubicación de diversas estructuras y la localización de la sección A-B representada a continuación]

[Sección a la altura del cuadro E, con indicación de diversos elementos sedimentarios y estructuras]

[Sección que corta los cuadros C-F, con indicación de diversos elementos sedimentarios]

[Página 13]

Afternoon. Fragment of what appeared to be a large urn appeared in F14 at about 1 p.m. This afternoon the urn was brought to light, and also the fragments of a further urn at right angle to it. The first urn had been crouched by the stones above it, and the second was in even worse state. In the angle between the two, and to the west, appeared fragments of various pots, some of very fine ware, and with [interred?] edges, others coarser. Photographs were taken of the whole complex (Roll I, 10, 11, 12).

[Planta de los cuadros 14 / E-F, con ubicación de diversas estructuras y hallazgos muebles]

A small polished stone adze came to light in the extreme Northern part of F14, slightly above the urns.

[Dibujo en vista frontal y sección longitudinal de la azuela de piedra, sin indicaciones métricas]

Adze, F14.

[Página 14]

Wednesday, 15th Nov. Morning. 8 men working. A new urn, oriented N.E. – S.W. came to light in Square E13, N.W. section. This was very much smashed by the pressure of the large stones which packed it in. The cleaning of Urn I (the best preserved), S2-50, was proceeded with, and the skeleton, much smashed, was partially uncovered. I was about during this period in Totana.

Afternoon. The cleaning of S2-50 continued, and the new vase photographed with the Contex.

Thursday, 16th Nov. Morning. 8 men working. The E-W wall in E14 was reprised, the doorway being filled in with stones, and a further layer of stones and earth being placed on top to preserve it.

[Planta de los cuadros 13-14 / E-F, con ubicación de diversas estructuras y tumbas en urna nº 2, 3 y 4]

[Página 15]

[Planta del cuadro F14, con ubicación de estructuras y, en mayor detalle, las tumbas en urna 2 y 3]

[Dibujo del interior de la tumba 2, que muestra la disposición de los principales restos esqueléticos. Anotación: "S.2-50"]

Depth. 0,95

1,05

[Dibujo de una cuenta de piedra, con vistas frontal y sección lateral. Anotación: "Stonebead (porphyry(?))"]

[Dibujo de un objeto plano perforado, seguramente un colgante, con vistas frontal y sección lateral. Anotación: "Stonependant"]

[Página 16]

[Planta del cuadro F13, con ubicación de estructuras y de las tumbas en urna 4 y 5]

[Planta del cuadro F14, con ubicación de estructuras y de las tumbas en urna 2 y 3]

IV.B. Measurements of pots v.[ery] approximate, owing smashed condition.

S4-50 cleaned. Yielded nothing, but smashed fragments of the top of the urn were found throughout. No traces of skeleton.

S3-50 yielded skeleton with skull smashed by large sherd, and a small dagger is left just below skull.

[Página 17]

S5-50, on urn, smashed on top and on the E. side appeared with same orientation as S4-50, to S.E. in same square. The mouth in this case was to the N.W.

Afternoon.

[Dibujo del interior de la tumba 3, que muestra la disposición de los principales restos esqueléticos y del ajuar: puñal y pendiente. Anotación: "S3-50"]

[Dibujo de pendiente de plata, con vistas superior y lateral, hallado en la tumba 3. Anotación: “Ring (Argentiferous lead (?))”]

S3-50. A second appeared by right ear, so seems were ear-rings.

Depth: 1,05

[Página 18]

[Dibujo de un cuchillo de dos remaches, con vista frontal y sección longitudinal. Anotación: “Dagger, Copper (?) S3-50”]

Also one small fragment of copper awl.

S-2-50 and S3-50 photographed previous to extraction of bones (Roll II 3, 4)

[En el interior de un recuadro: dibujo en vista lateral de un fragmento de peana de copa, con indicaciones métricas. Anotación: “Copa de cognac. F13, near S4-50 (Broken stand of Arg[aric] cup)”]

[Página 19]

S5-50 Depth 0,40

0,50

Friday, 17th Nov. Morning. 8 men working. The work of clearing S2-50 and S3-50 was continued and completed; the skull in both cases was saved intact. The sieving of the soil in S2-50 yielded two more fragments of the copper awl, and one further stone bead. Later 6 more beads, two being bone, the rest stone, appeared below the smashed pieces of urn.

The work of cleaning F15 was begun, and toward the end of the morning a copper ring was found in the déblais¹⁵⁹ below.

[Dibujo del anillo de una vuelta, con vistas superior y lateral. Anotación: “Ring, F15”]

The dismantling of S5-50 was begun.

Afternoon S5-50 finished. A few bones appeared, crushed, and pushed almost out of the remains of the urn, to the E. These were photographed, and the grave was then dismantled. Nothing appeared from the sieving of the earth.

¹⁵⁹. En francés: desmonte, escombros.

[Página 20]

In F14 appeared a wall continuing the E.-W. wall of E14. The layer of ashes, broader than was thought, continued under this. On the Northern side, a little above the burials S2-50 & S3-50 appeared a pot, upside down, and firmly fixed into the wall. Its mouth rested on virgin soil, and its neck passed through the ash layer. Photographed (Nos 6, 7, 8 of Roll II).

[Sección estratigráfica donde se recoge la posición de este recipiente de F5. Sobre esta sección se dibuja una ampliación de la zona ocupada por esa cerámica]

[Página 21]

Saturday, 18th Nov. Morning. The pot in E14, mentioned yesterday, was cleaned out. It appeared filled with stone some of quite large size, a certain amount of virgin soil (some of it appeared to have been backed hard by fire, and some black humus, intermixed with spots of charcoal towards the top[]). The top (i.e. the bottom of the vase) seemed to have been broken off before it was deposited in the soil. Some small fragments of pottery appeared among the stones near the mouth, and 4 minute fragments of bone were found among the earth.

Afternoon Further examination of the wall in which the pot appeared revealed a gap between it and the N.-S. wall, which later was [battered?] at the N.W. corner by a broadening which did not quite reach the height of the wall itself.

Remains of a further wall (height only one course of stones), running W. from S4-50. This seems a possible old wall which had fallen or been demolished in Argaric times. A further N.S. wall came to light in E12 and 13, near to F, with a well rounded angle in G13. At the moment it looks as if S4-50 and S4-35 were both outside the rooms.

[Página 22]

[Dibujo del cuadro F13 donde se representan en planta varias estructuras murarias y se localiza la sección A-B]

[Sección -plano A-B- de una de las estructuras representadas, acompañada de indicaciones métricas. Tal vez corresponde a la sección A-B indicada en la planta anterior]

[Dibujo ampliado de varios de los muros representados en la planta anterior, acompañados de varias indicaciones métricas y la localización de las secciones C-D y A-B]

[Sección –plano A-B- de una de las estructuras representadas, acompañada de indicaciones métricas]

[Página 23]

[Sección –plano C-D- de una de las estructuras representadas, acompañada de una indicación métrica]

Sections

[Sección en el plano A – B]

[Sección en el plano X – Y]

[Dibujo en sección de una pieza lítica, con indicaciones métricas. Anotación: “Mortar, E12 S.W. corner”]

[Página 24]

Sunday, 19th Nov Visit to Los Blanquizares and Campico de Lebor during the morning. Nothing found at Campico but potsherds, which were scattered over much of the area.

Monday 20th Nov Morning Digging continued in F11 and F10. The G squares were marked out for further advances. 10 men working.

I began the cleaning of a small pot which appeared in the G12 wall on Saturday afternoon, and photographed it (Nos (8, 9)-[spoiled¹⁶⁰] 10, 11, 12 of Roll II). The content, apart from soil, was one or two minute fragments of bone and charcoal.

[Sección de diversas estructuras murarias, posiblemente de los cuadros G-F, con diversas indicaciones métricas y la disposición de un vaso cerámico tapado por una losa]

[Página 25]

[Planta en cierto detalle de diversos muros ubicados en los cuadros G-F y la ubicación de la banqueta y de la vasija vertical tapada por una losa de pizarra, con diversas indicaciones métricas]

[Planta con las mismas estructuras recién mencionadas, aunque a una escala más grande, la guía de la cuadrícula (G-F) y diversas anotaciones métricas]

¹⁶⁰. En el sentido de “estropeado”, algo que puede ir bien si es que la foto se tomó o salió mal.

Afternoon F11 and 10 finished, also G10 and 11, and digging begun behind the wall in G12 and 13. In the W part of G10 and 11 appeared a wall of small stones running N.S., and with other walls beginning at right

[Página 26]

angles in an Easterly direction. These terminated after a few centimetres, however. The N-S wall has a revetment, only one store thick of the Cabezo.

In G13 there is an area which appears to have been previously disturbed. From this area came a small dagger of copper, with 3 rivet holes but only one remaining rivet. A piece of bone also appeared. An urn appeared in the SW. corner of G12, apparently entering H12.

[Dibujo del cuchillo de cobre, con vistas frontal y sección longitudinal; sin indicaciones métricas. Anotación: "copper 'dagger' from G13."]

Tuesday, 21th Nov. Morning 10 men working. Work continued behind wall in G12 and 13. A fragment of wall found, which was slightly visible above ground previously, having been cleared in a previous excavation (i.e. bombardment!). The reverse face of the original wall was cleared up and the cleaning of the G12 urn begun.

[Página 27]

[Planta de los cuadros 10-13 / F-G, que incluye la ubicación de diversas estructuras, incluida la tumba 6, la localización de dos secciones A-B y medidas de triangulación y de dimensión]

Afternoon Cleaning of G12 was (which proved an exceptionally large one) finished. Work begun on G14, 15, 16. One further small "mortar" found in G15.

[Dibujo del mortero, vistas lateral y superior, con indicaciones métricas. Anotación: "'Mortar' from G15"]

Part of G.12 urn was found to run into H12. The remaining part of F16 finished.

[Sección A - B en un lugar indeterminado]

Wednesday, 22nd Nov Morning. Proceeded to the clearing of H15, 16. Photographed urn (G12, H12), with Contax, plate and my camera (Roll III, 1, 2, 3). Dimensions of G12 urn: Length 0,85. Width 0,70. Mouth 0,65 Depth 0,90 m. 10 men working.

[Página 28]

[Sección de una estructura muraria, con indicaciones métricas. Localización indeterminada]

Afternoon Work in H15, 16 continued, and a further urn (v[ery]. smashed) came to light. In H15 and beside it a medium sized quern. The G12 urn was cleaned out, revealing two skeletons (with skulls v. smashed) and a magnificent cup (intact). This is the first complete cup to appear at La Bastida.

Thursday 23rd Nov Morning. 10 men working. Work continued in H15 and commenced in H16.

[Dibujo de una azuela de piedra incompleta, en vista frontal y una sección longitudinal. Anotación: "Adze from H15, depth 0,80"]

A fragment of stone adze (broken by pick & rest lost) was found in H15

[Página 29]

[Dibujo del interior de la tumba doble en urna S6-50, donde se aprecia la posición de los restos óseos y de parte del ajuar (copa). Anotaciones: "S6-50" y "Skull I should be somewhat larger"]

The cleaning of S6-50 finished and the result photographed with all three cameras (Roll III, Nos 4, 5 (spoiled), 6, 7, 8).

Afternoon Work continued in H14. One small perf. shell formal and several querns.

[Dibujo de una concha marina, en vista superior. Anotación: "Shell, perf[orated]. through vertex, from H15."]

Skull I of S6-50 proved to have a copper ring-pendant below the jaw.

[Página 30]

Friday 24th Nov Morning Halberd discovered in cleaning the bones from S6-50. It was wedged, below the vertebrae of the lower skeleton, near the pelvis.

[Dibujo del interior de la tumba S6-50, donde se muestra la colocación de los huesos y de diferentes piezas de ajuar: alabarda, dos pendientes y un punzón]

[Dibujo de la alabarda en vista frontal y una sección longitudinal. Sin medidas. Anotación: "Halberd S6-50"]

[Página 31]

[Sección estratigráfica en el plano H en la ubicación de la tumba S6-50]

[Sección estratigráfica en el cuadro H16, con indicaciones métricas Anotación: "Section in H"]

[Planta de los cuadros H15 y 16, con localización de algunos hallazgos e indicaciones métricas. Anotación: "Transverse section H16"]

[Página 32]

[Dibujo en vista superior y sección transversal de un molino, acompañado de indicaciones métricas]

[Dibujo en vista superior y secciones transversal y longitudinal de un molino, acompañado de indicaciones métricas]

[Una llave abraza los dibujos de ambos molinos y se acompaña de la leyenda "Querns H13"]

Flake of quartzite, H15 & querns fr. same

[Dibujo en vista superior y sección de la pieza de cuarcita]

[Dibujo en vista superior y secciones transversal y longitudinal de un molino, acompañado de indicaciones métricas]

[Dibujo en vista superior y secciones transversal y longitudinal de un molino, acompañado de indicaciones métricas]

[Página 33]

[Dibujo en vista superior y secciones transversal y longitudinal de un molino, acompañado de indicaciones métricas. Anotación: "Querns from H16"]

Bones, probably kitchen refuse, and a few pieces of charcoal came from H.15 among the querns. There are also 5 possible or broken querns from this H area, and 2 possible rubbin[g] stones.

Afternoon H13 finished a[nd] part of H12 along. One quern found in former a[nd] one superficially. The cleaning of S6-50 finished and a further awl (of cylindrical section) and 2 small pieces of copper found. The H15 urn cleaned. The urn was smashed unrecognizably, and only fragments were found. There was no traces of skeleton or grave-goods.

[Dibujo en vista superior y sección longitudinal y transversal de un molino, acompañado de indicaciones métricas. Anotación: "H12 Quern"]

[Página 34]

[Dibujo en vista superior y secciones transversal y longitudinal de un molino, acompañado de indicaciones métricas. Anotación: "Quern, found superficially, H12"]

A small “quartzite” flake appeared in H13

[Dibujo de dicha lasca en vista frontal y sección longitudinal, sin indicaciones métricas. Anotación: “Quartzite flake, H13”]

Saturday, 25th Nov. Morning. 10 men working. The fragments of S6-50 and the H15 urn cleared up and packed. Work proceeding in H12 out so far only a few fragments of pottery and a rough quartzite flake.

One certain and one possible urn found together in S.W. corner of H12, with a further small jar on the Western borderline a little further North.

[Página 35]

[Dibujo de una pieza de piedra tallada, con vistas de anverso y reverso y sección longitudinal. Sin medidas. Anotación: “Flake, H15”]

[Planta de los cuadros H11 y H12 donde se señala la ubicación de diversos hallazgos, a veces con medidas de triangulación]

Afternoon. A possible wall appeared in H11, along with two querns. Further on, almost in H10 appeared a small semicircular construction of smallish stones.

[Página 36]

[Dibujo en vista superior y secciones transversal y longitudinal de un molino, acompañado de indicaciones métricas]

[Dibujo en vista superior y secciones transversal y longitudinal de un molino, acompañado de indicaciones métricas]

Querns from H11

[Planta del cuadro H11 donde se muestran dos estructuras constructivas y se ubican mediante medidas de triangulación]

[Sección transversal que representa un plano a través de los cuadros H12, G12 y F12. Anotación: “Transverse section through H12, G12, F12”]

[Página 37]

[Dibujo de una F5, con indicación de varias dimensiones métricas. Anotación: “Pot from wall in G12”]

[Dibujo de una F7, con indicación de varias dimensiones métricas. Anotación: “Cup from S6-50”]

[Página 38]

Sunday, 26th Nov. 2nd visit to Campico. Found 2 blades of flint only. The area of settlement seems to me to be probably very limited.

Monday, 27th Nov Morning. 10 men working. Work continued in H10. One quartzite flake and possible urn found (H10). One quern and a large stone with a conical hollow worked at one end from H11. (Depth of latter 55 cms.)

Some fragments of a large tulipiform vase appeared at a depth of 40 cms apparently in the wall of H10.

[Dibujo de la lasca, con vista frontal y sección longitudinal. Sin medidas. Anotación: "Quartzite flake, H10"]

[Planta de los cuadros H10 y H11, que muestra la ubicación de varios hallazgos]

[Página 39]

[Dibujo en vista superior y secciones transversal y longitudinal de un molino, acompañado de indicaciones métricas. Anotación: "Quern, H10"]

[Dibujo en vista superior, dos secciones transversal y una longitudinal de la pieza lítica provista de cavidad cónica, acompañado de indicaciones métricas. Anotación: "Stone with hollow, H11"]

Then clearance of I10 & 11 begun. The greater part of I10 was completely sterile, the zone following the diagonal line of the H10 wall. To the N. of this line, however, the disturbed soil sank to a remarkable depth, of about a metre or more. A great part of the soil from here contained a debris of large stones, and appeared to be filling. The stones possibly come from some construction further W.

[Planta de los cuadros I10 e I11, con ubicación de varias estructuras y el hallazgo de una fusayola]

[Página 40]

[Dibujo de un objeto circular de cerámica, con vista superior y una sección longitudinal, con indicaciones métricas. Anotación: "Clay object fr. I11, found at depth of 1,30 m."]

[Dibujo en vista superior y sección longitudinal de una pieza lítica labrada, acompañado de indicaciones métricas. Anotación: "Broken stone with hollow (Mould?). I11"]

Afternoon The clearance of I10 and part of 11 finished. A semicircular wall appeared, half in 10 and half in 11, and other fragments of a possible complex of

walls connected with it. This was just above the area with the filling of stones referred to this morning. The stones probably proceeded from this wall.

Work begun in I12 with the intention of working back to I11 behind the vases. A quern found at the N. end of I12 at a depth of 85 cms.

[Dibujo en vista superior de un molino, acompañado de indicaciones métricas. Anotación: "Quern from I12"]

[Página 41]

[Dibujo en vista superior y secciones transversal y longitudinal de un molino, acompañado de indicaciones métricas. Anotación: "Broken quern, I12, [near?] former & at approx. same depth"]

Tuesday, Nov 25th Morning Part of I12 and the whole of I13 cleared to a considerable depth, but with no further finds. The walls in I10 and 11 were cleaned. 9 men working. Upon clearing the soil from behind the original semicircular construction in H11 it became evident that this was purely accidental arrangement of stones and had no existence. One of these stones proved to be a quern.

[Dibujo en vista superior y sección transversal de un molino, acompañado de indicaciones métricas. Anotación: "Quern, H11"]

[Página 42]

Afternoon 10 men working. Rest of I12 cleared a[nd] work continued to N. in I squares.

[Planta de los cuadros I-H / 10-11, donde se representa una estructura muraria y se la ubica mediante medidas de triangulación y la localización de la sección A-B]

[Sección de la citada estructura por el plano A-B]

[Planta ampliada de la citada estructura, con dimensiones métricas]

[Página 43]

Wednesday, 29th Nov Morning The clearing of the new wall, I11 (Northern extreme) end of the enormous quantities of earth from Squares I12, 13, 14, continued. The new wall is about 1,60 cms. high at this W. extreme, when the soil of the Cabezo rise sharply. A few small pieces of charcoal and 3 quartzite flakes came from the base of the disturbed soil, a few cms to the N. of the W. extreme of the wall (I12). Depth 1,60 m.

[Dibujo de una de las lascas de cuarcita citadas –probablemente sílex oolítico-, con vista frontal y sección longitudinal, sin indicaciones métricas]

[Dibujo de una de las lascas de cuarcita citadas –probablemente sílex oolítico-, con vista frontal y sección longitudinal, sin indicaciones métricas]

[Dibujo de una de las lascas de cuarcita citadas –probablemente sílex oolítico-, con vista frontal y sección longitudinal, sin indicaciones métricas. Anotación: “Quartzite flakes, I12”]

[Página 44]

[Planta de los cuadros H-I / 11-12, donde se indica la ubicación de varias estructuras y hallazgos muebles entre los que figuran las tumbas 7, 8 y 9]

A quern from I13

Afternoon Some earth still remained to be removed from I12, and the area of the urns (H, I12[]) is to be cleaned. A quern and hand of mortar (huge stone with long hollow in one side) came from the area between the two (H12). The urn which enters [it?] seems to be only some large fragments of the base of the wall when it is parallel with the latter appears a large fragment of pot & human bones, including the whole or part of a skull. This will have to be investigated tomorrow. A small fragment of a bone point has also been found [in] I12, when fragments of pottery, of animal bones and charcoal are quite frequent. A fragment of what appears to be a polisher was also found in this area a[nd] a small bone which seem

[Página 45]

[Dibujo en vista superior y una sección longitudinal de un mortero, acompañado de indicaciones métricas. Anotación: “Mortar’ H12”]

[Dibujo en vista superior y secciones transversal y longitudinal de un molino, acompañado de indicaciones métricas. Anotación: “Quern, H12”]

to be ringed by 2 deliberate grooves, one at either end. A further quern comes from I13.

[Dibujo de un hueso con ranuras, con dos vistas laterales y sin medidas. Anotación: “Grooved bone, H13”]

[Dibujo de la punta de un punzón de hueso fragmentado, con una vista frontal y una sección longitudinal. Sin medidas. Anotación: “Bone point (fragment) I12”]

[Dibujo de un pulidor, con una vista frontal y una sección longitudinal. Sin medidas. Anotación: “Polisher’ (¿) H12”]

[Página 46]

[Dibujo en vista superior y una sección longitudinal de un molino, acompañado de indicaciones métricas. Anotación: "Quern I13"]

[Dibujo de una pieza de sílex, con vista frontal y una sección longitudinal. Sin medidas. Anotación: "Flint flake (honey colour, I13)"]

Thursday, 30th Nov Morning. Went a visit to Aledo (Roll III, 9, 10, 11, 12).

10 men working. Clearing of deeper levels in I13 begun, a[nd] the same level (1,80 - 1,90) as in I12, & I11 reached. . In I14, [near?] I13 appeared a fragment of a cup at a depth of 1,40 m. Various remains of urns found. The clearing of H12 urn begun.

S7-50 Small, much smashed urn, with skel.[eton] of child. Small shallow bowl of v.[ery] good quality paste by sherd.

[Dibujo del interior de la tumba 7, que muestra la posición del esqueleto y del cuenco y molino]

[Dibujo de un cuenco bajo de F2; vista lateral con indicaciones métricas. Anotación: "Bowl, S7-50"]

[Dibujo en vista superior y secciones transversal y longitudinal de un molino, posiblemente calzo de la tumba 7, acompañado de indicaciones métricas. Anotación: "Quern S7-50"]

[Página 47]

Body extended with legs twisted up towards head.

Afternoon S7-50 photographed (Roll IV, No I) and then dismantled. The pot was found to be broken, but hold together by the earth inside.

The skull at the base of the I12 wall was investigated and turned out to be a much smashed double interment in one urn. The skulls appear to be in good condition by some miracle. The small jar in I12 was only sherds, but just to the S. of this appeared a few human bones connected with sherds of an urn. (S8-50)

The clearing of I14, 15, 16 begun.

Friday, 1st Dec. Morning S9-50 (the double interment) cleaned for photographing. The upper part of a large cup appeared to the E of the skulls.

In I14, 15, 16 appeared remains of various E.-W. walls. These were followed into J14, 15, 16, and the Squares J10-J16 were marked out. 10 men working.

Afternoon S8-50 cleared. Skulls came out whole, as did cup (a fragment of same). The clearing of I15, 16 continued.

[Dibujo del interior de la tumba 9, donde se indica la posición de diferentes partes esqueléticas. Anotación: "S9-50"]

[Página 48]

[Dibujo de la parte superior de una copa sin pie, con indicación de medidas. Anotación: "Fragment of cup, S9-50"]

Saturday 2nd Dec Morning 10 men working. The cleaning of J14, 15, 16 finished, and that of J 13, 12 embarked upon. There is a sudden rise of the ground above the J line, and from then on the layer is very shallow so that the clearing of these squares proceeded rapidly. The two walls found yesterday were followed through these squares, but the furthest North disappeared shortly after entering J. The fragments of a pot were found on the dividing line between I & J13. These were removed, and found to be merely sherds. They were surrounded by a mass of fine hardened clay. Depth approx. 1,80

The interments S8-50, S9-50 were cleared completely. Apart from one or two bones and a sherd or two, nothing fresh appeared in this process. S9-50 appears only to contain remains of one skeleton, and these incomplete. The lower jaw of one of the skulls (prob. Skull I, which seems to be that of a youth) is still missing.

[Página 49]

Afternoon

[Planta del cuadro I13, indicando la localización de los fragmentos y arcilla rota]

[Planta de los cuadros 14-16 / I-J, donde se muestra la ubicación de varias estructuras y se detalla su localización mediante medidas de triangulación]

J12 and 13 finished

Sunday, 3rd Dec. Visited Cabezo de Juan Cormaon [¿Clímaco?] for second time, but found nothing notable except the pits of earlier excavators.

Monday, 4th Dec 10 men working. J11 and 10 cleared and found to be completely sterile like most of J12 and 13. The cleaning of the stones from A, B and A 14-16 begun so that these can be excavated or left clear for the future.

[Dibujo en vista superior y secciones longitudinal y transversal de molino, acompañado de indicaciones métricas. Anotación: "Quern found resting on top of S. corner of semicircular wall in I10"]

[Página 50]

Afternoon The clearing of stones from B and A 14-16 finished and digging begun in B16. The cleaning of earth from the J squares continued all day.

[Dibujo de un fragmento de copa, con diversas medidas. Anotación: "Fragment of cup from I14 (lower part of that from S9-50)"]

Tuesday, 5th Dec. Clearing of earth excavated from I10, 11 and 12 continued.

C15 commenced. Barren, as C16.

C14 commenced.

Clearing of I10, 11 and 12 finished and clearing of earth from C squares proceeded with 10 men.

Wednesday, 6th Dec During this morning the clearing of earth from the C squares was finished and 1,50 m of the corresponding B squares was excavated without further finds.

[Página 51]

[Planta de los cuadros J11 y J12 con representación de varias estructuras acompañadas de medidas]

[Sección transversal a través de un plano indeterminado de la excavación]

FINIS.

